

**ADDENDUM NUMBER THREE**

for

**USC School of Journalism Broadcast Studio  
Project No.: U-646-12-3  
State Project Number: H27-6099-MJ**

COLUMBIA, SOUTH CAROLINA

PREPARED BY:

The Boudreaux Group 1200 Park Street Columbia, South Carolina 29201

DATE OF ISSUE: November 26, 2014

TO: ALL BIDDERS OF RECORD, CONSULTANTS, OWNER:

The following items shall take precedence over the drawings and specifications for the above named project and shall become a part of the contract documents. Where any item called for in the specifications, or indicated on the drawings, is not supplemented hereby, the original requirements shall remain in effect. Where any original item is amended, voided or superseded hereby, the provisions of such item not specifically amended, voided or superseded shall remain in effect.

**CONTRACTOR SHALL ACKNOWLEDGE RECEIPT OF ADDENDUM.**

This addendum consists of 3 pages and on drawing attachment as listed: E0.2.

**I. General Clarifications:**

1. As indicated at the pre-bid conference and issued via addendum #2, the rose bushes in the rose garden impacted by the project will be relocated and reinstalled by the owner. Tree protection should be provided for landscaping to remain as indicated on L-0.

**II. Architectural Specifications:**

1. Specification Section "095113 Acoustical Panel Ceilings"
  - a. Section 2.2.A - Add Armstrong to the list of approved manufacturers.
  - b. Section 2.4.A - Add Armstrong to the list of approved manufacturers.
2. Specification Section "084113 Aluminum Storefront Entrances and Storefront"
  - a. Section 2.2.A – Add Coral Architectural Products to the list of approved manufacturers, subject to compliance with the project documents. Manufacturer is to comply with all requirements in specification section "084113 Aluminum Storefront Entrances and Storefront" including the following items:

USC School of Journalism Broadcast Studio

Addendum Number Three

- i. Storefront system must show compliance with all performance requirements, including Water Penetration under Dynamic Pressure test AAMA 501.1.
- ii. Storefront system must be provided with frame and subframe sizes indicated on drawings and to accept glazing thicknesses as indicated on the documents.

**III. Electrical Drawings:**

1. Reference Drawing E0.1 – In Electrical Symbol Legend, all audio fire alarm indicating devices shall be speaker type.
2. Reference Drawing E0.2 –clarification of the overall distance for the power feeder from the existing adjacent USC Health Sciences building to the new Broadcast Studio.
3. Reference Drawing E1.1 – In Lighting Notes, to clarify Note 4, the contractor shall provide a DMX “on-off” relay and coordinate connection with broadcast equipment for the automatic operation of “on air” sign.
4. Reference Drawing E1.3 – In Fire Alarm Single Line Diagram, add note that reads, “Fire alarm system for this building shall have capability of mass notification (ATI) announcements. Provide all required interface (i.e. wiring and modules) to connect this panel with the main fire alarm panel.

**IV. Electrical Specifications:**

1. Specification Section 267210 – Fire Alarm System – In Paragraph 1.8, change spare parts to read quantities of one for each piece of equipment listed.
2. Specification Section 267210 “Fire Alarm System” – In Paragraph 2.6, change “Fire and Voice Command Center” to standard “Fire Alarm Control Panel.” The capability of making voice announcements from annunciator or control panel is not required.

**V. Electrical Prior Approvals for Lighting Fixtures:**

<u>Type</u>	<u>Manufacturer</u>	<u>Catalog Number</u>
A	Elite Spectrum	SC6-LED DIM10-PM24-FINISH-RL60714W-DIM10-120-30K-MB-BK SPC0611LEDXI-11W-30K-WD-DO101/6454XI-BK-PMXX-CC
AE	Elite Spectrum	SC6-LED DIM10-PM24-FINISH-RL60714W-DIM10-120-30K-MB-BK with Philips ELI-S-20 SPC0611LEDXI-11W-30K-WD-DO101/6454XI-BK-PMXX-CC emergency
B	Lithonia Prescolite	EVO 35/10 6AR 120 4PS24-232G-FSA12125-EU-PAF
BE	Lithonia	EVO 35/10 6AR 120 with Philips ELI-S-20 USC School of Journalism Broadcast Studio

	Prescolite	4PS24-232G-FSA12125-EU-EL141-PAF
C	Lithonia Columbia	2SP8 G 2 32 A12125 MVOLT GEB10IS LPSM841
CE	Lithonia Columbia	2SP8 G 2 32 A12125 MVOLT GEB10IS EL14 LPSM841
D	Lithonia Columbia	2AV G 3 32 MDR MVOLT GEB10IS LPSM841 STE24-332G-MPO-3EU-PAF
F	Lithonia Columbia	SB 2 32 MVOLT GEB10IS WC4-232-EU-PAF
G	I-2 Systems	V2355B-24-8-CBC-OUT
H	Lithonia	FMML 7 840 WL
JE	Lithonia Columbia	C 2 32 MVOLT GEB10IS NST WGCUN EL14 CS4-232-EU-1PK-EL141-PAF/CSWG4
K	EELP Beghelli	SPWLEX 2 R W "ON AIR" USA FTZ-HT-LR-2-U-WW-SW (ON_AIR)
OA	Antique Street  Spring City	LT30 K 150M MED ACT GR5 277 CS RAL7026 Pole: PA C20 14A CS RAL7026 William and Mary Medium 150W MH Pole: 14'0 Washington
X	Emergi-lite Lithonia Lightalarms	LSNX-42/42-N-R-C/M-UA LRP 1(2) RMR DA 120/277 EL N SPLEDNWRMDX

END OF ADDENDUM

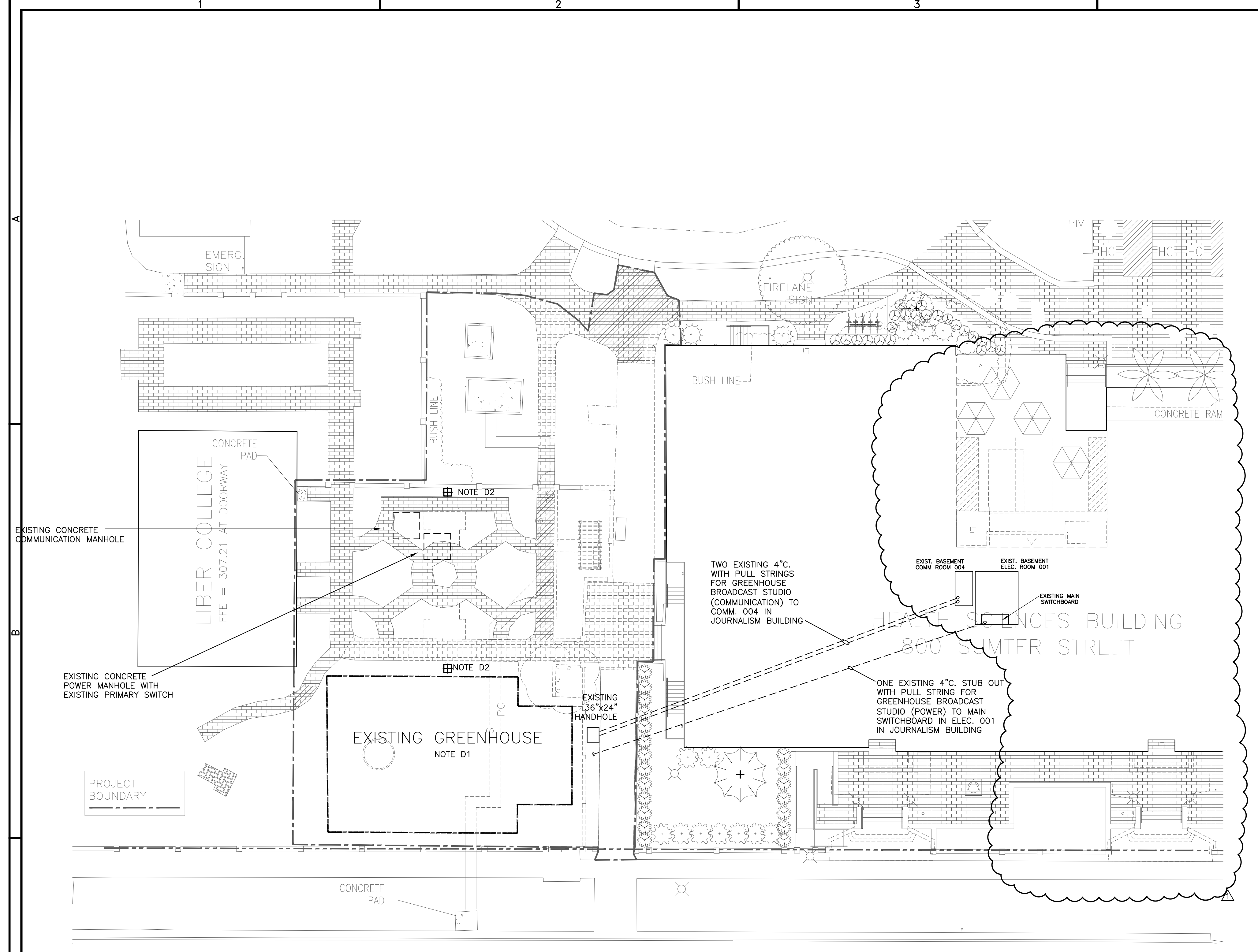

**1 ELECTRICAL SITE DEMOLITION PLAN**  
 E0.2 SCALE: 1/16" = 1'-0"

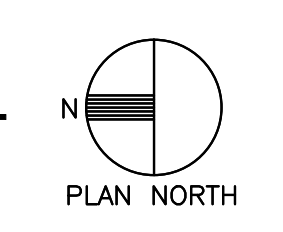

**ELECTRICAL SITE DEMOLITION NOTES**

D1. ALL ELECTRICAL WITHIN AND ON THE GREENHOUSE SHALL BE DEMOLISHED.

D2. REMOVE EXISTING LIGHT FIXTURES/POLES AND TURN OVER TO OWNER. EXTEND EXISTING CIRCUITS IN CONDUIT TO NEW FIXTURES/POLES AS REQUIRED.

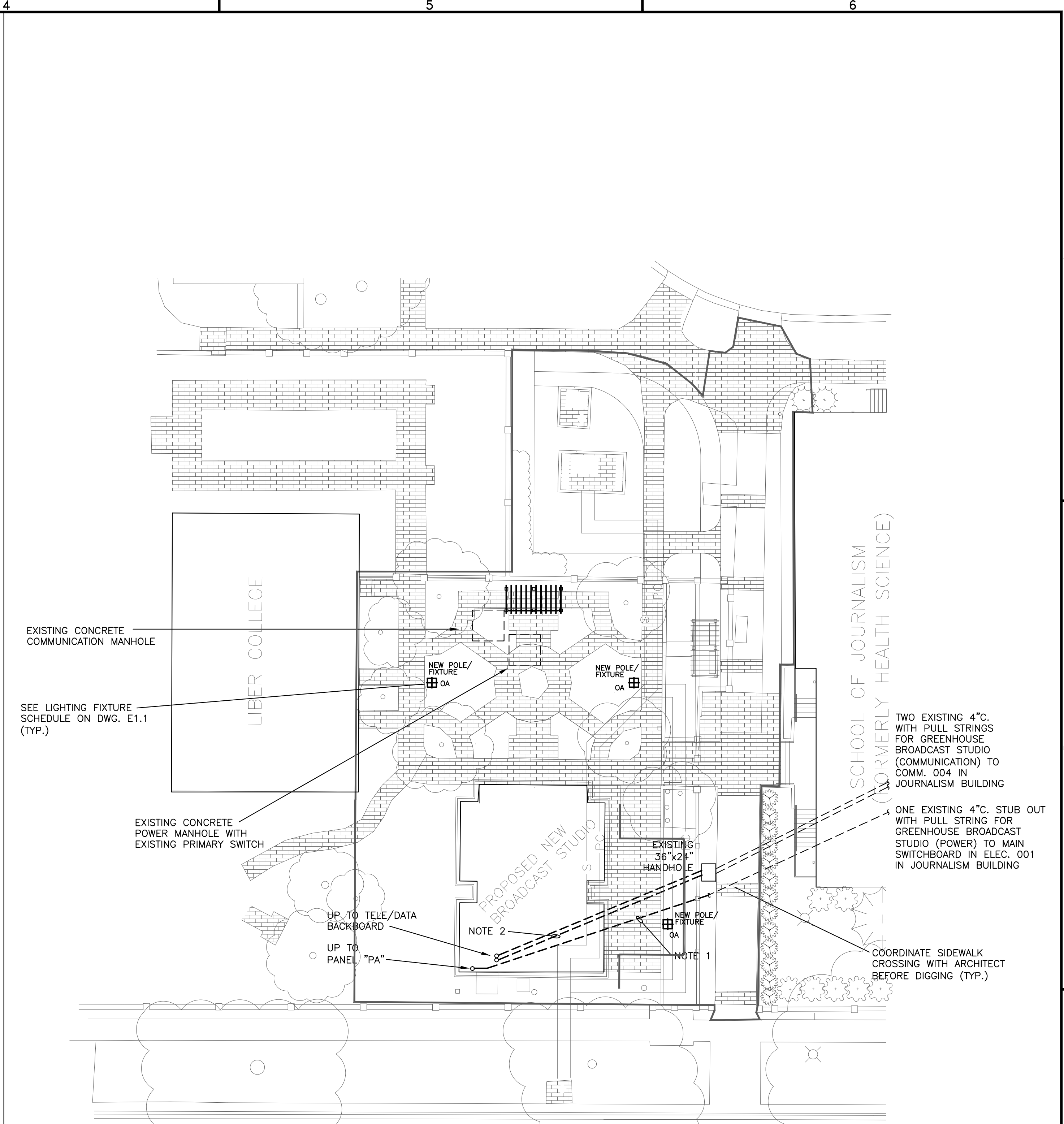

**2 ELECTRICAL SITE RENOVATION PLAN**  
 E0.2 SCALE: 1/16" = 1'-0"

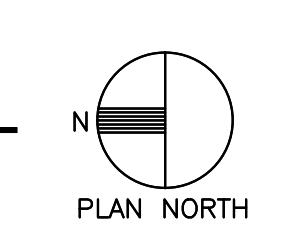

**ELECTRICAL SITE RENOVATION NOTES**

1. EXTEND 4" CONDUIT STUB OUT FROM USC SCHOOL OF JOURNALISM (SOJ) BUILDING FOR BROADCAST STUDIO MAIN POWER PANEL "PA". PROVIDE 4-500kcmil, 1# 3 GND. AND CONNECT TO EXISTING 400 AMP, 3 POLE BREAKER IN USC-SOJ SWITCHBOARD (BASEMENT LEVEL).

2. PROVIDE TWO 4" CONDUITS WITH PULL STRINGS FROM EXISTING HANDHOLE TO NEW BACKBOARD LOCATION.

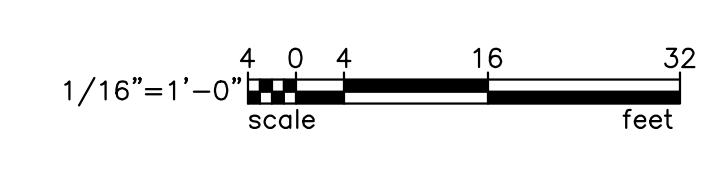

**BEA** BELKA  
 ENGINEERING  
 ASSOCIATES, INC. AB21310

7 CLUSTERS COURT, SUITE 201  
 COLUMBIA, SOUTH CAROLINA 29210  
 (803) 731-0650 fax (803) 731-2880  
 EMAIL: CEStringfield@bellsouth.net

**The Boudreaux Group**  
 The Boudreaux Group, Inc.  
 1330 Lady St., Suite 300 (opposite)  
 Columbia, SC 29201  
 803.799.0247 P.  
 803.777.6844 F.  
 info@boudreauxgroup.com

**Interdisciplinary Design. Architectural Interior Planning**

**UNIVERSITY OF SOUTH CAROLINA**  
 ENGINEERING  
 ASSOC. INC. No. C00953  
 STATE OF SOUTH CAROLINA  
 REGISTERED PROFESSIONAL ENGINEER

**UNIVERSITY OF SOUTH CAROLINA**  
 ENGINEERING  
 ASSOC. INC. No. 26181  
 STATE OF SOUTH CAROLINA  
 REGISTERED PROFESSIONAL ENGINEER  
 0-1-14  
 APE 1000

**UNIVERSITY OF SOUTH CAROLINA**  
 SCHOOL OF JOURNALISM  
 BROADCAST STUDIO  
 BID DOCUMENTS  
 COLUMBIA, SOUTH CAROLINA

Project Title  
 UNIVERSITY OF SOUTH CAROLINA  
 SCHOOL OF JOURNALISM  
 BROADCAST STUDIO

Drawn By  
 JJS

Checked By  
 JCS

Date  
 11.26.14

ADDENDUM NO. 3

10.3.14

**ELECTRICAL  
 SITE PLANS**

**E0.2**